

SHOWER HINGE

SUITABLE FOR: A90.10, A90.11, A90.12, A90.13

This is a basic guide—some factors can change the installation process.

GLASS TO GLASS INSTALLATION (STEPS 1 - 4)

- 1) Attach the plastic shield and gaskets to the hinge.
- 2) Install the glass. Suitable for glass up to 10mm thick; an extra plastic gaskets is included for thinner panels.
- 3) Secure the hinge plate and spacers with the provided fixings. Tighten the screws with an Allen key to clamp the glass in place.
- 4) Ensure clearance under the door or drip rail. Clearances may vary depending on the shower door drip rail supplier.

GLASS TO WALL INSTALLATION (STEPS 1 - 6)

- 5) Drill holes at the marked spots and insert wall plugs.
- 6) Attach the hinge and glass to the wall using the provided fixings.

Specifications:

Glass Thickness: 8mm to 10mm
Closing Type: Self-centering when within 25° of closed position
Cutout Required: See diagram

Maximum Door Capacities:

Using 2 Hinges: Max Weight (36kg), Max Width (711mm)
Using 3 Hinges: Max Weight (54kg), Max Width (813mm)

Use of Gaskets:

For 10mm Glass: Use one thick gasket on each side
For 8mm Glass: Use one thick and one thin gasket on each side

Recommendations:

Do not exceed the maximum door capacity weight or width
Do not use power tools when installing these hinges
Fasten all of the fixing screws

Cut out template:
(to scale)



GLASS TO GLASS INSTALLATION - Use left and right of template below

GLASS TO WALL INSTALLATION - Use only one side of template below

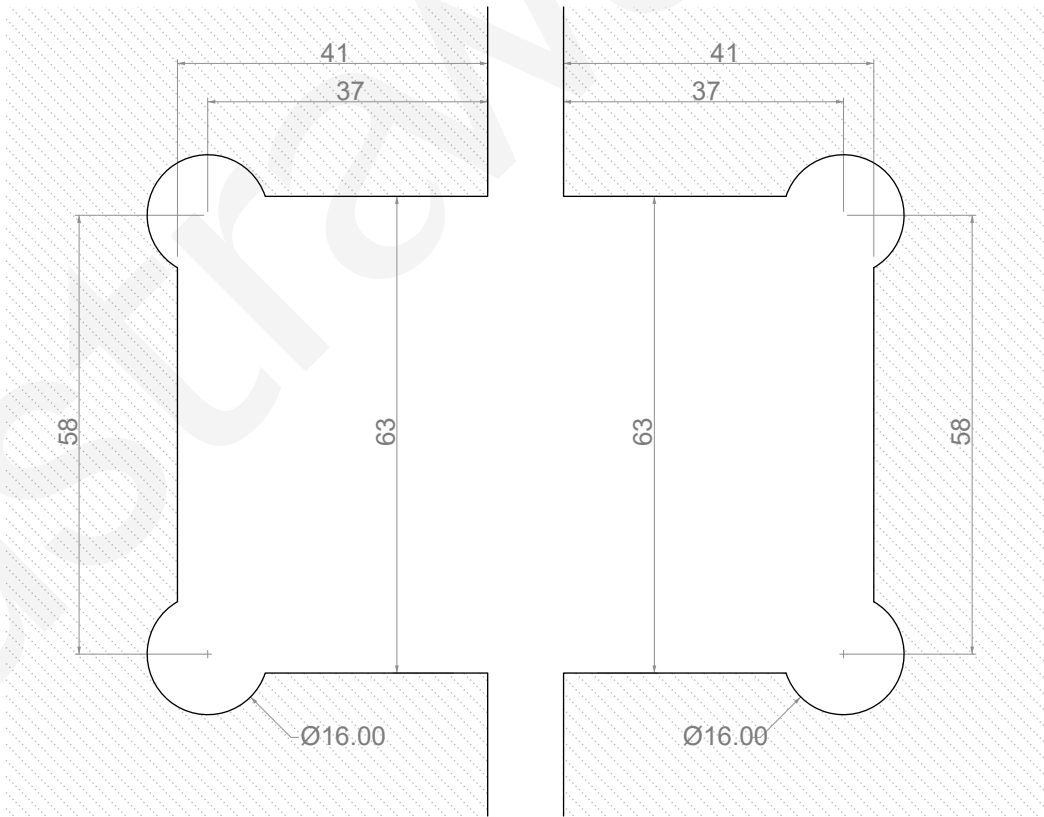

NOTE This product must be installed by a licensed trade